

TOP VIEW

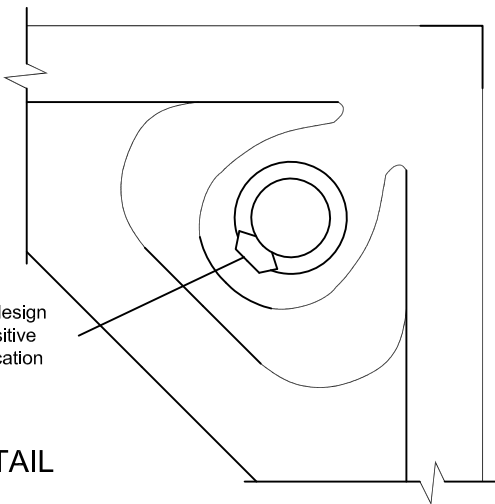

CORNER DETAIL

SPECIFICATIONS

General information

- Panel weight : 9.0 lbs./ft² bare.
- All steel welded construction filled internally with a cementitious core material.
- Protected from corrosion by an epoxy paint finish.
- Class A flame spread rating.
- Non-combustible material.

UNDERSTRUCTURE OPTIONS

- Posilock
- 2' Bolted Stringer 4' Bolted Stringer

COVERING OPTIONS

Tile factory laminated with integral trim edge

- 1/8" HPL _____ (Color) _____
- 1/16" HPL _____ (Color) _____
- 1/8" Conductive HPL _____ (Color) _____
- 1/16" Conductive HPL _____ (Color) _____

For additional laminate options contact Inside Sales

Bare Painted Panel Options

- Bare Painted Finish to accept carpet tile application
- Bare Painted Finish to accept PosiTile application

Bare Panel

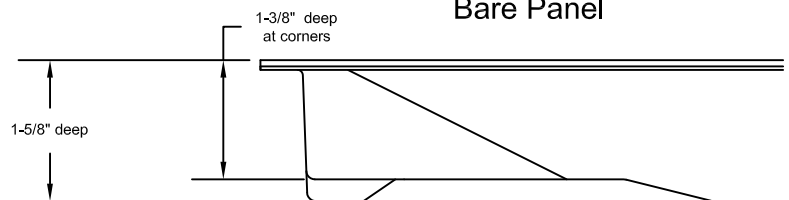

Laminated Panel With Integral Trim

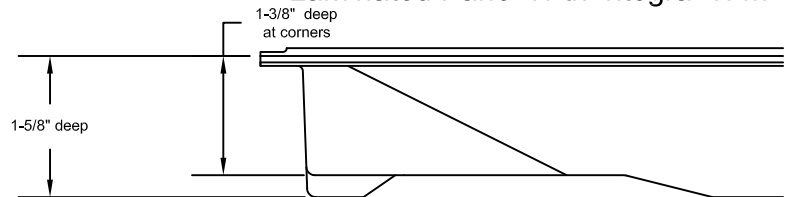

System Performance Criteria (Tested on Actual Understructure)*

System Type	Understructure	SYSTEM WEIGHT	STATIC LOADS			ROLLING LOADS		IMPACT LOADS
			Design Loads	Ultimate Loads	Safety Factor	10 Passes	10,000 Passes	
ConCore CC1500-24"	Posilock	9.0 lbs / ft ² 44 kg / m ²	1500 lbs 680 kg	Min. 3000lbs Min. 1360kg	Min. 2	1250 lbs 567 kg	1000 lbs 454 kg	150 lbs 68 kg
ConCore CC1500-24"	Bolted Stringer	10.5 lbs / ft ² 52 kg / m ²	1500 lbs 680 kg	Min. 3000lbs Min. 1360kg	Min. 2	1250 lbs 567 kg	1000 lbs 454 kg	150 lbs 68 kg

1. System Design Load is based on permanent set $\leq 0.010"$ and is verified by loading panels in accordance with the CISCA concentrated load method but with panels installed on actual understructure instead of steel blocks. (Testing on blocks does not represent performance of an actual installation.) Ultimate, Rolling, and Impact Load tests are performed using CISCA test procedures.

2. Safety Factor is Ultimate Load divided by Design Load.