

Bolted Stringer Understructure for ConCore[®] and All Steel Floor Panels-24". Type 8IFSW 7/8.

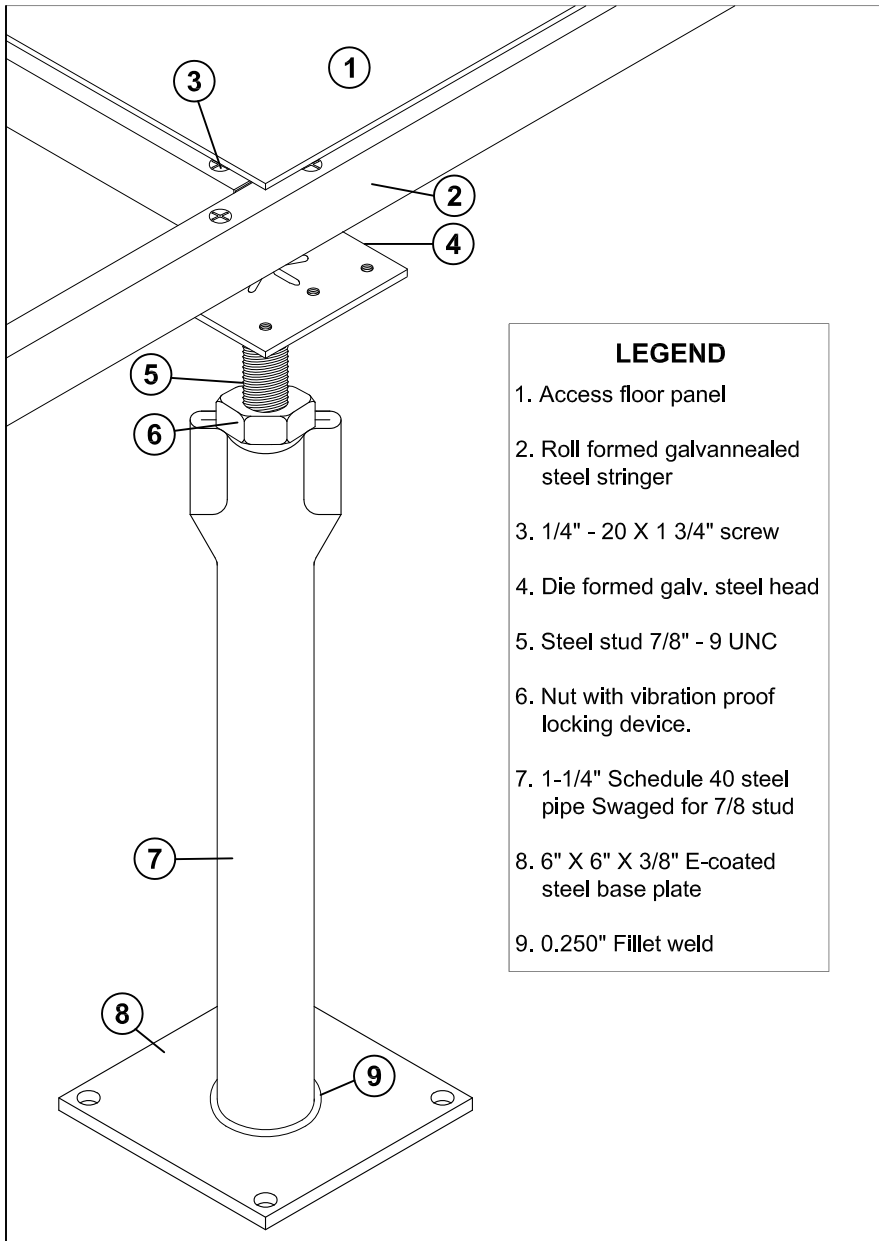

| LEGEND | |
|--------|---|
| 1. | Access floor panel |
| 2. | Roll formed galvanized steel stringer |
| 3. | 1/4" - 20 X 1 3/4" screw |
| 4. | Die formed galv. steel head |
| 5. | Steel stud 7/8" - 9 UNC |
| 6. | Nut with vibration proof locking device. |
| 7. | 1-1/4" Schedule 40 steel pipe Swaged for 7/8 stud |
| 8. | 6" X 6" X 3/8" E-coated steel base plate |
| 9. | 0.250" Fillet weld |

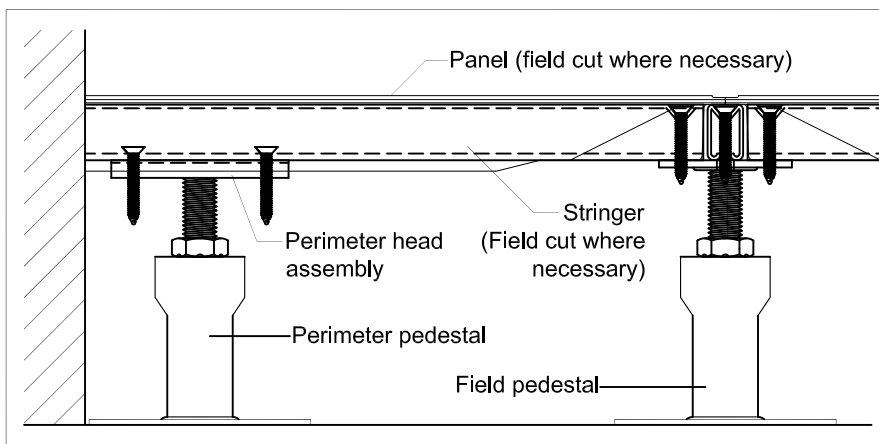

PEDESTAL SPECIFICATIONS

Pedestal Assembly

- Assembly up to 72" FFH shall provide a 10,000 lb. axial load without permanent deformation. Other heights available upon request.
- Assembly shall provide a 2" total adjustment.
- All pedestal components and fasteners are completely electro-zinc free.

Pedestal Head

- Standard head is 11 ga. die formed galvanized steel pedestal head and resistance welded stud with adjustment nut. Heavy duty head for CC2000 and CC2500 panels is 8 ga. fillet welded for field and tack welded perimeter head. Head and installed stringers shall provide perimeter support for panel.
- Stringers shall be attached with 1/4" - 20 flat-head screws.
- Pedestal head shall be tapped for engagement of stringer screws.
- Steel stud shall be 7/8" - 9 UNC.
- 7/8" - 9 UNC locking nut with corrosion resistant coating.

Pedestal Base

- 1-1/4" Schedule 40 steel pipe (with 1.66" O.D.) shall be reduced to 7/8" inner diameter by swaging.
- Tube fillet welded to 6" X 6" X 3/8" steel base plate.
- Base plate shall have (4) 9/16" diameter holes at 4.875" center to center distance for fixed equipment applications.
- Assembly shall have rust prohibitive electrocoated epoxy finish.

Stringers

- Heavy duty roll formed steel stringer shall be 1-1/4" deep X 3/4" wide and shall withstand 450 lb. mid-span load.
- ConCore 2500 panels require the 4' x .054" stringer. All other panels except the ConCore 3000 use the .048" stringer
- Stringer shall have galvanized coating to prevent corrosion.
- Stringer grid pattern shall be 4' by 4' basketweave.

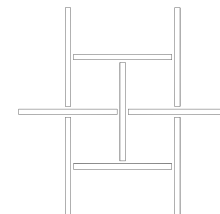

Perimeter

- Perimeter pedestal shall provide support for panels around columns, at walls, curbs and fascia.